

# Manual Instruction

## Zigbee 3.0 5-in-LED Strip Controller

Model No.: LM052

Please read the instructions carefully before using the controller.

### 1. Features

- 16 Millions of colors to choose
- Color temperature 2700K~6500K
- Dim brightness / saturation
- Support music rhythm
- Tap-to-Run & automation
- Free screw when connecting to LED strip
- Link/Unlink/Reset Button on the controller
- Auto-transmitting & Synchronization
- WiFi wireless control
- Smartphone APP control
- Support third party voice control
- Support remote control (control distance 30m)
- Device sharing
- Group control
- 2.4G wireless transmission technology

### 2. Parameters

Model No.: LM052  
 Input Voltage: DC12V~24V (5.5\*2.1mm)   
 Output: 6A/Channel ( Total Output Max. 15A)  
 Working Temperature: -20~60°C  
 RF: 2.4GHz  
 Weight: 65g



Smart Link&Unlink: We have 3 methods to Link and Unlink to APP.  
 1. Long press "SET" 3 seconds, the purple will blink 3 times, the device go into Smart Link/Unlink mode.  
 2. Use Linked 091 remote, long press the linked Zone ON button for 3 seconds, the purple light will blink 3 time, the device go into Smart Link and Unlink Mode.  
 3. Switch ON and OFF 3 times(ON-OFF-ON-OFF-ON) within 10 seconds, the purple light will blink 3 time, the device go into Smart Link and Unlink Mode.

Switching Output Mode: Short press "SET" button to switch the output mode; The indicating lamp flickering means switching successfully; Different colors ON correspond to different output mode; Details see below sheet.

White Light ON	Yellow Light ON	Red Light ON	Green Light ON	Blue Light ON
Single Color Mode	Dual White Mode	RGB Mode	RGBW Mode	RGB+CCT Mode (Default Mode)

**Suggestion:** Complete the network distribution of the equipment first, then adjust the ouput mode Pilot lamp.

### 3. Auto-synchronization function

Different controllers can work synchronously when they are started at different times, controlled by the same remote, under same dynamic mode and with same speed.

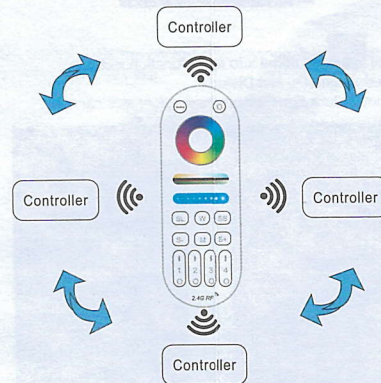

Remark:

1. Indicating Auto-transmitting.
2. Controller will be auto-synchronizing in the same dynamic modes and within 30m controlling distance.